

Bonnie Brae Lane

(50' Wide)

Concrete Curb & Gutter (South 150.0')

N0°16'47"W 150.01'

(105.00')
104.98'

(70.0')

Lot 4

House 1195

Porch

Lot 5

Gazebo

Tax Parcel
ZWE 00004

0.407 Acre
17,721 Sq.Ft.

West 118.41'
(117.71')

South Street

(66' Wide)

Lot 52

Lot 7

Lot 6

Plat of Survey

of

Lot 4 and the West 1/2 of Lot 5 of H.E. Wells Addition,

a subdivision located in the Northeast 1/4 of Section 1,
Town 1 North, Range 17 East, City of Lake Geneva,
Walworth County, Wisconsin.

Surveyed for: **RE/MAX Geneva Realty, Ltd.**

101 Broad Street
Lake Geneva, Wisconsin. 53147

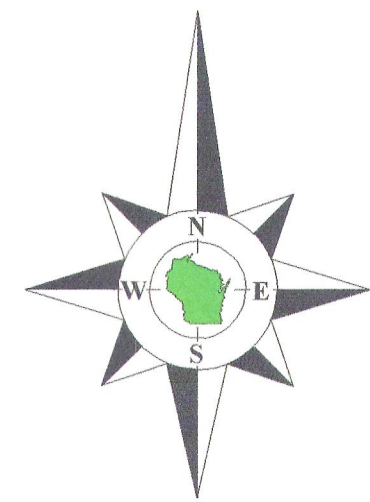

Bearings reference to the plat
of H. E. Wells Addition.

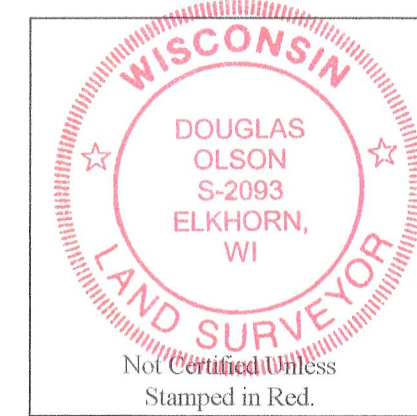

Notes:

- 1) This survey plat is not certified unless signed and sealed in red ink.
- 2) This survey is subject to Wisconsin lien laws. This Plat of Survey is the notice of intent to file lien. Lien waiver required.



Copyright 2011 by Jensen & Olson Land Surveying, LLC.

All rights reserved. No part of this survey plat may be reproduced or transmitted in any form by any means - graphic, electronic, or mechanical, including photocopying, tracing, or information storage and retrieval systems - without permission in writing from Douglas G. Olson, Jensen & Olson Land Surveying, LLC.

I hereby certify that I have surveyed the above described property and the map hereon is correct to the best of my professional knowledge and belief and shows the size and location of the property, its exterior boundaries, the location and dimensions of all visible structures thereon, boundary fences, apparent easements and roadways and visible encroachments, if any.

This survey is made for the exclusive use of the present owners of the property, and also those who purchase, mortgage or guarantee title thereto, within one year from the date hereof.

Douglas G. Olson
Wisconsin Registered Land Surveyor - 2093

Survey Date: September 8, 2011.
Revisions:

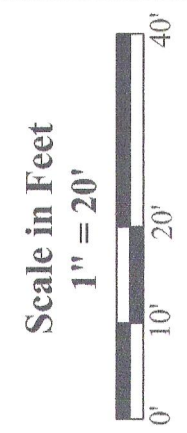

Jensen & Olson Land Surveying, LLC

45 South Wisconsin Street * P.O. Box 322 * Elkhorn, Wisconsin. 53121
Telephone: (262) 723-3434 * Facsimile: (262) 723-8044
Email: jensen.olson@elknet.net

- Legend**
- Found Concrete Monument
 - Found Iron Pipe
 - Set Iron Pipe, 1" dia.
 - Recorded Information
 - Utility Pole
 - Water Valve
 - Catch Basin
 - Asphalt Surface
 - Concrete

Sheet 1 of 1 Sheets
Drawing Name: H:\1102-2011\102Plat.scd
Job Reference Number
2011.102

2011.102

ZWE-4

007-2833